

Adapter is a part of measuring installation (especially of pipelines), where a sensing element (temperature sensor) is installed by means of threaded connector. Selection of parameters and design depends on measuring installation conditions. It is manufactured in accordance with individual client requirements.

Specification

Material*

stainless steel 1.4541
carbon steel 15 HM

Dimensions*

thread D: M20x1,5mm, G½
length L [mm]: 50÷200

Type

straight: MP
slanted (45°): MS

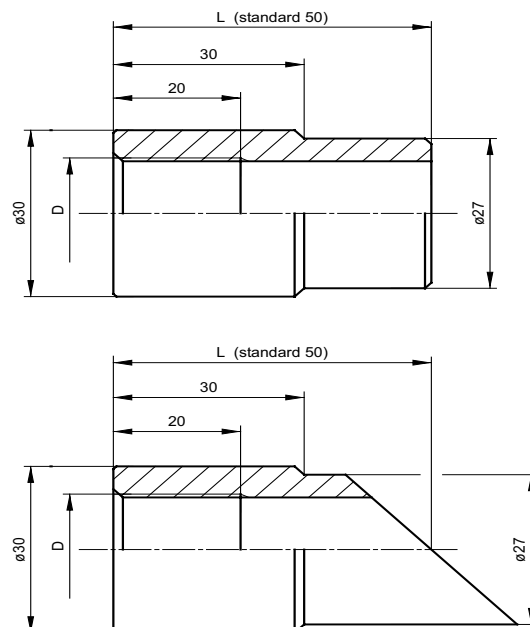

Product code

Type		
1	P	straight
	S	slanted
Thread dimension D		
2	M20x1,5	M20x1,5
		other parameters acc. to requirements
Length L		
3	50	50mm
		other parameters acc. to requirements
Material		
	1.4541	acid-resistant steel
	15HM	15HM

1 2 3 4
M - - - -

Ordering example:

Welding adapter MP-50-15HM