

# Fitting accessories - Valves



## Needle valve VM-1

Material 316ss

Medium temperature, working pressure – according to the graph on page III/ 7

Ordering code:

**Valve VM-1/M** (input M20x1/5 M, output M20x1/5 F, Teflon packing)

**Valve VM-1/G** (input G1/2" M, output G1/2" F, Teflon packing)

**Valve VM-1/graphite** (input M20x1/5 M, output M20x1/5 F, Graphite packing)

**Valve VM-1 oxygen** (valve designed for contact with oxygen; input M20x1/5 M, output M20x1/5 F, Teflon packing)



## Needle valve VM-1-R/R

Material 316ss

Medium temperature, working pressure – according to the graph on page IV/ 3

Input 1/2NPT F, output 1/2NPT F, Graphite packing, no vent port

Ordering code:

**Valve VM-1-R/R/**

- 1 – Set of weldable stainless steel connectors (316ss)
- 2 – Set of weldable steel connectors (K1/562)
- 3 – Set of connectors with Ø1/2 clamping ring
- 4 – Set of connectors with Ø1/4 clamping ring

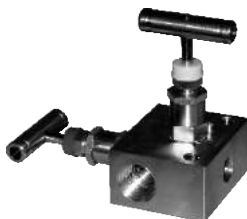

## 2-Valve Manifold VM-2

Material 316ss

Medium temperature, working pressure – according to the graph on page IV/ 3

Input 1/2NPT F, output 1/2NPT F, Teflon packing, vent port 1/4 NPT F

Ordering code:

**Valve VM-2-R/R/**

**Valve VM-1-R/R/**

- 1 – Set of weldable stainless steel connectors (316ss)
- 2 – Set of weldable steel connectors (K1/562)
- 3 – Set of connectors with Ø1/2 clamping ring
- 4 – Set of connectors with Ø1/4 clamping ring

Option

.../NACE - NACE compliance



## 2-Valve Manifold VM-2-RM

Material 316ss

Medium temperature, working pressure – according to the graph on page IV/ 3

Input 1/2NPT F, output 1/2NPT F, Teflon packing, vent port 1/4 NPT F

Ordering code:

**Valve VM-2-RM/M** (input M20x1/5 M, output M20x1/5 F, Teflon packing, vent port 1/4 NPT F)

**Valve VM-2-RM/G** (input G1/2" M, output G1/2" F, Teflon packing, vent port 1/4 NPT F)

**Valve VM-2-RM/1/2NPT** (input 1/2"NPT M, output 1/2"NPT F, Teflon packing, vent port 1/4 NPT F)

Option:.

.../NACE - NACE compliance



## Ball valve

Material – H17N1/4M2 (316 ss)

Medium temperature - 80°C

Max pressure - 100 bar

Input, output process connection: 1/2NPT F

Ordering code:

**Valve VM-1/B**

## Transmission tubes

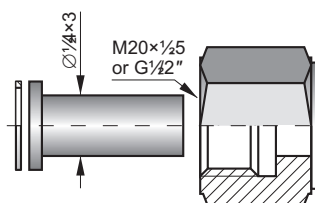

Connector to weld  
Materials: 1/5HM – (SO) or 316Lss (S)

Ordering code

**RedSpaw – S or SO / M20x1.5 or G1/2"**

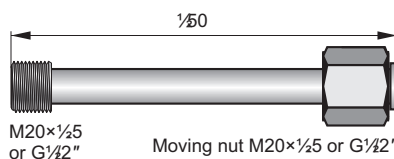

Impulse line

P<sub>max.</sub> 100bar

Materials: R35 – (SO) or 321ss (S)

Ordering code

**Impulse line – S or SO / M20x1.5 or G1/2"**

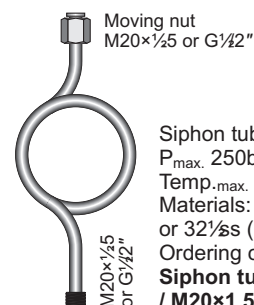

Siphon tube

P<sub>max.</sub> 250bar

Temp<sub>max.</sub> 300°C

Materials: R35 – (SO)

or 321ss (S)

Ordering code

**Siphon tube – S or SO / M20x1.5 or G1/2"**

## Fitting sockets

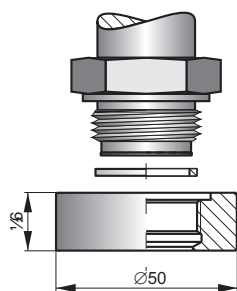

Socket with M30×2 thread for fitting transmitters with a CM30×2 process connection  
Material – 316Lss  
Sealing – teflon  
Ordering code **Socket CM30×2**

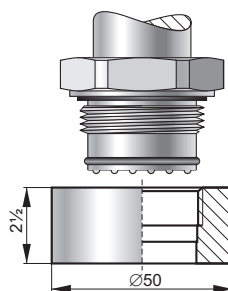

Socket with G1/2" thread for fitting transmitters with a CG1/2 process connection  
Material – 316Lss  
Sealing – teflon  
Ordering code **Socket CG1**

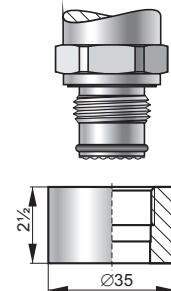

Socket with G1/2" thread for fitting transmitters with a CG1/2 process connection  
Material – 316Lss  
Sealing – teflon  
Ordering code **Socket CG1/2**

## Adapters

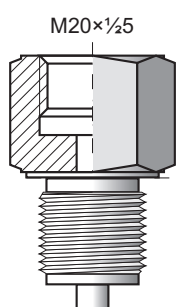

Material – 316Lss (S)

Ordering code: **Red**

Dimension of male thread



**R1/2"**



**1/4NPT**



**M12×1.5**



**G1/4"**



**1/2"NPT F  
1/4"NPT F**

Material – brass

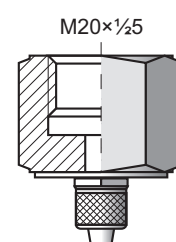

**Ø6×1 elastic tube**

Ordering code:  
**RedØ6 – M**

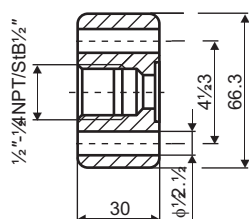
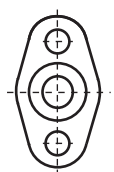

Adapter for differential pressure transmitters with C type process connection  
Material – 316Lss

Ordering code: **Red-dP/1/2" NPT**

## Mounting brackets

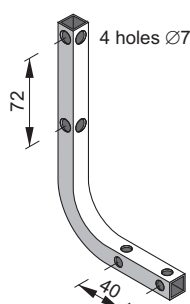

Clasp for fitting on a pipe

Universal mounting bracket for fitting APC-2000 and APR-2000 transmitters with aluminium casing in any desired position on a vertical or horizontal pipe (Ø30...Ø50)

Ordering code:  
**AL:**material zincd steel  
**AL(SS):**material stainless steel



Mounting bracket for fitting differential pressure transmitters with C type process connections on a 2" pipe or on a wall

Ordering code:  
**C-2"**: material zincd steel  
**C-2"(SS)**: material stainless steel

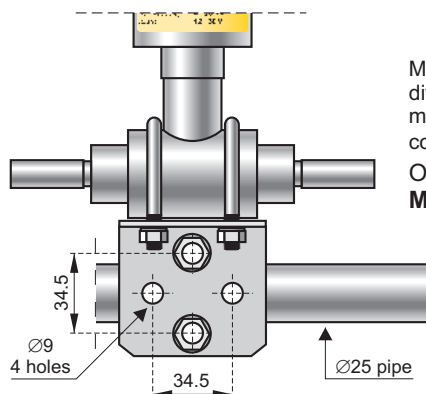

Mounting bracket for fitting differential pressure transmitters with P type process connections on a Ø25 pipe.  
Ordering code:  
**Mounting bracket FI 25**

## Notes

